

• **ABOUT US** •

Driven by the passion for innovation, we at Dr Trust endeavour to provide our customers with the latest medical inventions with an objective to promote good health and wellness all around the world. All the medical devices and health monitors provided by Dr Trust are supported by accurate, latest and ground breaking technologies, innovated at our headquarter in NY, USA. All our products adhere to the most stringent CE and FDA guidelines and are strongly recommended by doctors and health practitioners. Our products are designed in the utmost exemplary ways to ensure that their accuracy and convenience are unrivalled. The ease of their use and operation makes them even more suitable for users of all age groups.

Dr Trust strives to enhance the quality of lifestyle by providing with the most trusted and innovative health care and wellness products. Being a renowned global leader in health care products, Dr Trust ensures that our technically efficient team works dynamically and tirelessly to provide the best of the medical devices to our clients. The products that we have to offer are suitably designed for use at homes, laboratories and hospitals.

Our ground breaking solutions allow you to monitor your health in the easiest ways possible. In today's era when all of our lives are too hassled to handle, it becomes a bit difficult to pay attention to our health. But it has now become easier with the coming of the monitoring devices which can be conveniently used at homes and even on the go.

We bring to you a variety of best self medical devices, trusted and used by Doctors, medical professionals and home users all over the world.

Dr Trust

Dolphin Humidifier – 904

• **QUICK STARTUP GUIDE** •

IMPORTANT

Reservoir capacity is 2 Liter

Step 1

Put the humidifier on flat dry surface.

Step 2

Remove the water tank from the base.

Step 3

Unscrew the water tank cap and fill it with cold & clean water.

Step 4

Close the cap of water tank and

Step 5

Place the water tank on the base.

Step 6

Plugin power supply and switch on the humidifier by using on/off dial.



• INTRODUCTION •

Dr Trust Home Spa Humidifier – 904 is ideal to be used in baby's room, living room, hall, bedroom, gym, office, yoga place and at many other places. It increases the moisture in the air to neutralize the dryness & harmful particles to reduce the possibility of airborne conditions arising from them. It purifies air & reduces inflammation and skin allergies. It also prevents many other dry air health ailments including asthma, congestion, throat infections, dry skin, dry lips, and other breathing issues. A humidifier is helpful in increasing moisture in the air. It is ideal for use in areas where air conditioners are present. It helps in relieving stress & soothes mind.

• SAFETY INSTRUCTIONS •

Please read the instruction manual carefully prior using the product. While using the appliance, it is necessary to observe some precautions. Improper operation may result in personal injury to the user or other people, as well as damage to property.

- Humidifier is designed to work in habitable rooms under the stated operating conditions.
- Using the humidifier not for its intended purpose may create situation dangerous or life and health threatening.
- This is an electric appliance, so while in operation, should be under supervision, especially if it is used in a room with children.
- Please, make sure that children do not play with the appliance.
- Use the appliance only in accordance with the user manual.
- Never use the humidifier with a damaged power cord or plug and if the humidifier is broken or damaged by falling or in other circumstances.
- It should be operated only in the fully assembled condition.
- To avoid a burn, do not touch the membrane of the operating humidifier.
- High frequency of oscillations results in heating of the membrane.

- The appliance is not intended for use by persons (including children) with physical, sensory, or mental disabilities, or having insufficient experience and knowledge, if they are not under supervision and have not received instructions for use of the appliance from a person responsible for their safety.

NOTE:

- High-frequency oscillations of the ultrasonic humidifier membrane are noiseless and safe for people and pets.
- To avoid the electric shock, the damaged power cord should be replaced only in authorized service centers by qualified specialists.
- To avoid the electric shock, do not place the power cord near heating appliances and inflammable or combustible materials.
- To avoid traumas and property damage, do not try to repair the humidifier by yourself.

Unplug the humidifier in the following cases:

- before discharge or filling of a tank with water.
- before cleaning and maintenance.
- before assembling/disassembling of elements.
- before displacement of the humidifier.
- Install the humidifier on flat dry surface. Outgoing steam may damage exposed surfaces.
- Do not install the humidifier on the floor, as well as near heating appliances, walls, furniture, and other objects.
- The manufacturer and suppliers are not responsible for damages caused by incorrect position of the humidifier.
- The humidifier should be installed on a rise – e.g., on a table, pedestal, etc.
- Never fill the water in the humidifier through a diffuser.
- Do not immerse the humidifier in water or other liquids.
- Do not install the humidifier in a passage or in other places, where it can be touched, overturned, etc.



- If the humidifier is not in use, unplug it.
- Do not lay a power cable under a carpet or other objects. While placing the humidifier be careful that you do not touch the power cable by accident.
- Do not use the humidifier in damp rooms.
- Prevent the ingress of foreign objects into the humidifier.
- Do not block an air intake and the diffuser with foreign objects.
- Do not sit or stand on the humidifier and do not put heavy objects on it.
- The manufacturer and vendor are not responsible for damages of the humidifier caused by non-fulfillment of this requirement.
- While unplugging the humidifier, do not pull the power cable and do not touch it with wet hands.

• **APPLIANCE DESCRIPTION** •

1. Water outlet
2. Watertank
3. Water scale window
4. Float holder
5. Float
6. Knob
7. Water inlet
8. Indicative light
9. Base

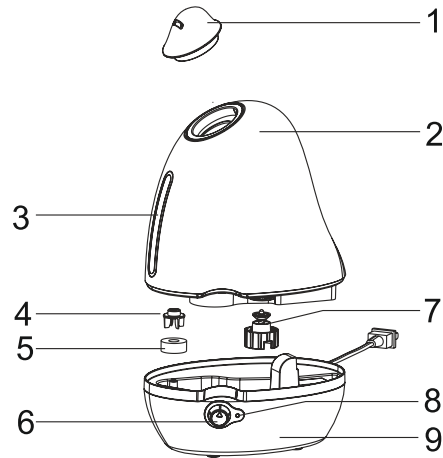

• **FILLING OF TANK WITH WATER** •

Always unplug the unit before removing the water tank. Do not touch the water in the base during operation.

- Remove the water tank from the base and unscrew the water tank cap.
- Make sure that no foreign objects are in the water tank.
- Fill the tank with clean, cold water from the tap. Close the cap of the water tank securely; place the water tank onto the base.
- Do not pour water into the mist outlet of the appliance.
- Insert the plug into the socket and switch on the appliance using the on/off dial.

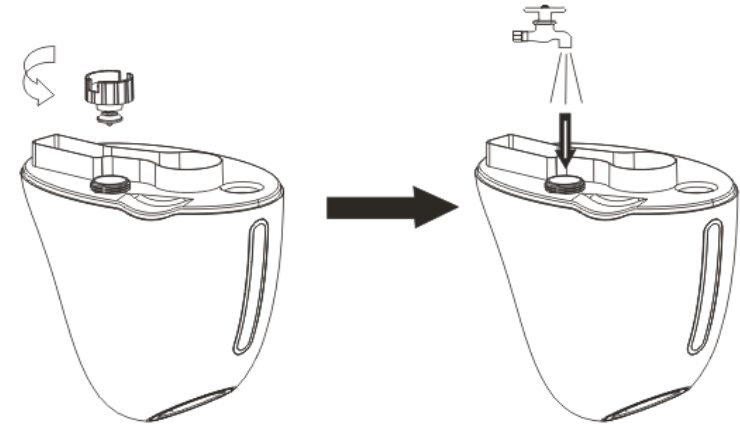

• **APPLIANCE OPERATION** •

Connect to power & turn the knob "ON". The product will make beep sound indicating that it is on. Red light indicates lack of water. Turn off & fill water. Adjust the frequency of mist by adjusting the knob. Do not move appliance in working state.



TROUBLESHOOTING

In case of emergency, please, use the troubleshooting methods shown in tables. If it is impossible to solve problem with these methods, contact our customer care.

Problem	Possible Cause	Remedy
Poor atomizing (insufficient capacity)	The unit is operating in the minimized mode (low atomizing frequency)	There is no problem. If you need to switch to the intense mode of operation, turn the regulator handle all the way to the right.
	The atomizer is clogged	Clean the atomizer.
	Temperature of water in the tank is too low	Set maximum capacity. The diffuser's capacity will go up after a while.
No atomizing	The power cord is poorly connected to the outlet	Connect the power cord into the outlet carefully
There is white deposit on objects around the diffuser (salts, separating out from water)	1. Lime deposits have formed on the membrane 2. There are lot of salts in the water used (calcium and magnesium)	1. Clean the diffuser's membrane with a special brush 2. Use filtered water
Steam has an unpleasant odor	Stale water is used Remains of stale water or waste have accumulated in the unit's case or the atomizer	Clean the unit according to the cleaning and servicing instructions and fill the tank with fresh & pure water

Condensate is formed on the upper part of the diffuser and on surrounding objects, when it is operating.	1. High humidification intensity is set. 2. High room humidity and temperature.	Lower the humidification intensity by turning the on/off and steam outflow intensity regulator counterclockwise.
Water appears next to the diffuser, when it is operating.	1. High humidification intensity is set. 2. Lime deposits have formed on the membrane and in grooves for water (in the unit's base).	1. Lower the humidification intensity by turning the on/off and steam outflow intensity regulator counterclockwise. 2. Clean the unit according to the cleaning and servicing instructions.
Water appears/accumulates next to the diffuser	Water tank is leaking	You need to contact an authorized service center

TRANSPORTATION AND STORAGE

- When transporting, any possible impacts and movements of the package inside a vehicle must be avoided.
- Handling symbols on the unit's package must be strictly observed when transporting and storing it.

Temperature requirements*	Transportation and storage	-30 °C to +50 °C 15% to 85 % (no condensate)
Humidity requirements*		

Note*: Products must be stored in dry, ventilated storages at the temperature not lower than -30°C.



• **SPECIFICATIONS** •

Humidification capacity	280 ml/h
Power supply	220-240v/50-60Hz
Water tank	2.0 L
Rater power consumption	25 W
Nominal current	0.11 A
Moisture protection class rating	IPxO
Electrical protection class rating	II
Device dimensions	206x145x265 mm
Net weight	0.74 kg
Recommended floor space	20-25 m2

• **CLEANING AND MAINTENANCE** •

The manufacturer reserves the right to change the set-list of the device (including liquid and powder components) for different supplies without prior notice. The changes either in no way influence the basic technical parameters of the device or may improve them, and not violate the legislation or quality standards of the countries of manufacture, transit and selling. The changes in the set-list may result in changing of the weight and dimensions of the device, but not more than by +\ -5-20% (depending on the product category).

• **IN THE BOX** •

1. Air humidifier – 1
2. Manual and warranty card – 1
3. Package – 1

• **CUSTOMER SUPPORT** •

CONTACT ADDRESS

USA

Nureca INC.USA
276 5th Avenue, Suite 704-397,
New York (NY) - 10001, USA

INDIA

Corporate Office (Mumbai)

Nureca Limited
128 Gala Number Udyog Bhavan,
1st Floor Sonawala Lane, Goregaon East
Mumbai City Maharashtra 400063

Contact us

India: +91-7527013265 /+91-9356658436

Website: www.drtrust.in

Corp Website: www.nureca.com

Email: customercare@nureca.com

Connect with us on social networks

Facebook: @drtrust

Instagram: @drtrustisin

Youtube: NurecaUsa

COPYRIGHT©2021 NURECA LTD ALL RIGHTS RESERVED



Scan to View
Product Demo Video
www.drtrustusa.com/904