

## • OVERVIEW •

Driven by the passion for innovation, we at Dr Trust endeavour to provide our customers with the latest medical inventions with an objective to promote good health and wellness all around the world. All the medical devices and health monitors provided by Dr Trust are supported by accurate, latest and ground breaking technologies, innovated at our headquarter in NY, USA. All our products adhere to the most stringent CE and FDA guidelines and are strongly recommended by doctors and health practitioners. Our products are designed in the utmost exemplary ways to ensure that their accuracy and convenience are unrivalled. The ease of their use and operation makes them even more suitable for users of all age groups.

Dr Trust strives to enhance the quality of lifestyle by providing with the most trusted and innovative health care and wellness products. Being a renowned global leader in health care products, Dr Trust ensures that our technically efficient team works dynamically and tirelessly to provide the best of the medical devices to our clients. The products that we have to offer are suitably designed for use at homes, laboratories and hospitals.

Our ground breaking solutions allow you to monitor your health in the easiest ways possible. In today's era when all of our lives are too hassled to handle, it becomes a bit difficult to pay attention to our health. But it has now become easier with the coming of the monitoring devices which can be conveniently used at homes and even on the go.

We bring to you a variety of best self medical devices, trusted and used by Doctors, medical professionals and home users all over the world.

## Dr Trust

### Cool Mist Humidifier 4.5 L – 907

## • QUICK START GUIDE •

#### Step 1

Position your humidifier on a flat surface, and then remove the water tank cover.



#### Step 2

Fill the tank with pure and clean water.



#### Step 3

Do not add water exceed the Max line.



#### Step 4

Do not pour water into the mist tube which will cause malfunction.



#### Step 5

You can add essential oils into the water tank to enjoy the aroma therapy.



#### Step 6

Put the water tank cover on, plug in and turn it ON.



## • OVERVIEW •

Dr Trust Cool Mist Humidifier 4.5 L – 907 is a 2-in-1 device that works as humidifier and aroma diffuser. It has 4.5 L water storage capacity and whisper-quiet working sound to ensure a perfect sleeping for users without the worry of frequently adding water.



It is very efficient and effective device with advanced features like 360-degree rotatable nozzle, purification filter, high quality PP housing, essential oil supportiveness and lots more. It improves the quality of air in your home with the emission of aroma therapy oils and some splendid scents.

## • KEY FEATURES •

- Can hold up to 4.5 L of water
- Can work for 12-22hours
- Compact size and easy to operate through turn knob control
- PP housing gives it a more premium and sophisticated look
- Ultrasonic technology to run quietly
- Easy to clean and refill
- Comes with water scarcity protection for safe use

## • KEY COMPONENTS •

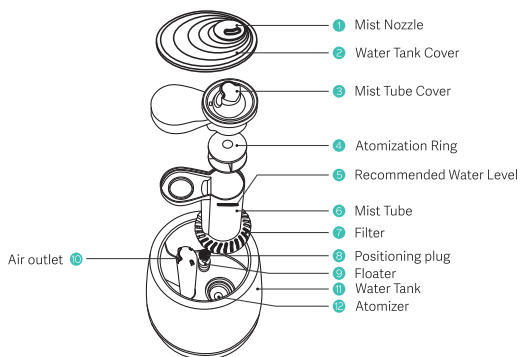

## • MIST TUBE ASSEMBLY •

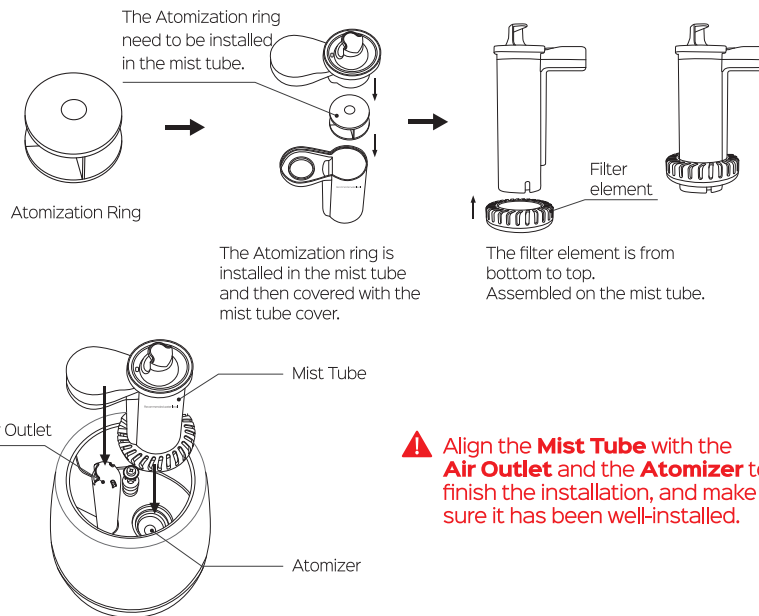

**⚠️ Align the **Mist Tube** with the **Air Outlet** and the **Atomizer** to finish the installation, and make sure it has been well-installed.**

### Note

- ✓ For noise-sensitive users, please do not place the device near the ear while sleeping. It is recommended to place the device 3.3 ft (1m) away from the human body.
- ✓ We do not recommend taking off the lid to fill water when the humidifier is running.



## ● OPERATION GUIDE ●

- Before use, please clean the water reservoir with mild soap and water to clean out any residue from the manufacturing process.
- Once the reservoir is cleaned, place the humidifier on a flat raised surface (like on the top of a stool or bedside table) at least 15 inches away from walls.
- Remove the reservoir top cover and fill it with pure and clean water. Use distilled water as it is going to be free of any additives that may contain in tap water.
- There is a marked water line on the water reservoir. Do not add water above this Max line mark. You can also add essential oils into the water tank to enjoy the aroma therapy.
- Put the water tank cover back on the top. Plug in and power on the humidifier.
- It has a knob to adjust the settings as per personal preferences. When not in use, turn off the humidifier.

## ● KEY NOTES ●

- Assemble the mist tube before filling water.
- Add water around the mist tube. Do not add water to the mist tube or air outlet as it will cause malfunction.
- Do not move the humidifier around under working conditions to avoid water leakage or water overflow.

## ● CLEANING AND MAINTENANCE ●

1. Turn off the humidifier before cleaning. Clean the water tank, base, and atomizer regularly.



2. Change the water in the tank frequently to keep the humidifier interior clean.



3. If there is scale inside the water tank, pour some citric acid in and let the scale soak for half an hour. Then rinse it with clean water. Finally, please pour the water out of the tank in the correct direction.

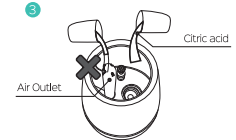

4. When cleaning weekly, use a soft towel or cotton swab to clean the surface of the atomizing sheet. If there is thick scale on the surface of the atomized sheet, the mist output will be affected.

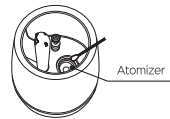

5. If there is scale on the surface or inside the mist tube, disassemble it and rinsed with water one by one, then wiped clean with a clean towel and assemble back.



6. It is recommended to clean once a week for better performance or atomization.

7. To prevent dry burn, there will be some accumulated water in the base. It is a normal phenomenon and with no worry to use it.

#### Note

- Do not immerse the entire product in water to prevent the danger of short circuit.
- Please remove the mist tube and then clean the tank.
- Do not use water to clean the air outlet when cleaning the water tank.

### IMPORTANT SAFETY INSTRUCTIONS

- If the supply cord is damaged, it must be replaced by a well qualified person to avoid a hazard.
- This appliance can be used by children aged from 8 years and above and persons with reduced physical, sensory, or mental capabilities or lack of experience and knowledge. Only they must have been given supervision or instructions concerning use of the appliance in a safe way and to make them understand the hazards involved.
- Children shall not be allowed to play with the appliance.
- Cleaning and user maintenance shall not be made by children without supervision

- Unplug the appliance during filling and cleaning.
- If the tank is full of water but there is no mist output, please check the assemblies to make sure that it's all parts are aligned well with the water supply port.
- Please keep the product away from wall at a distance about 15cm when in use.

### TECHNICAL SPECIFICATIONS

Water Tank Capacity	4.5 L
Continuous Running Time	12-22 Hours
Power	30 W
Voltage	220-240V~50Hz
Mist Output	180-350mL/h
Essential Oils Supportive	Yes (can add oil into water tank directly)
Atomization Method	Advanced Ultrasonic Technology
Purification Filter	Yes



Material	High quality PP Housing and PP Transparent Water Tank
Operation Control	Turn Knob Control
Safety	Water Scarcity Protection
Sound Level	Low noise≤38dB
Product Net Weight	1.15kg
Unit Dimension	215*215*290mm

## CUSTOMER SUPPORT

### CONTACT ADDRESS

#### USA

Nureca INC.USA  
276 5th Avenue, Suite 704-397,  
New York (NY) - 10001, USA

#### INDIA

Corporate Office (Mumbai)  
Nureca Limited  
128 Gala Number Udyog Bhavan,  
1st Floor Sonawala Lane, Goregaon East  
Mumbai City Maharashtra 400063

#### Contact us

India: +91-7527013265 /+91-9356658436

Website: [www.drtrust.in](http://www.drtrust.in)

Corp Website: [www.nureca.com](http://www.nureca.com)

Email: [customercare@nureca.com](mailto:customercare@nureca.com)

Connect with us on social networks

Facebook: @drtrust

Instagram: @drtrustisin

Youtube: NurecaUSA

COPYRIGHT©2021 NURECA LTD ALL RIGHTS RESERVED



Scan to View  
Product Demo Video  
[www.drtrustusa.com/907](http://www.drtrustusa.com/907)